

TOP VIEW

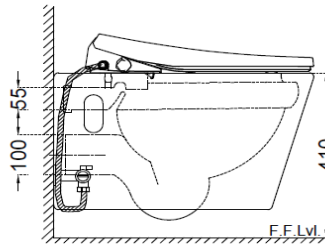

SIDE VIEW

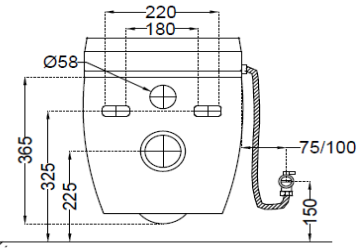

BACK VIEW

GENERAL INFORMATION

Product Code	SPS-WHT-81953PP
Brand	Jaquar
Colour	White
Type	Wall Mounted WC - P TRAP
Material	Ceramic-Vitreous China (VC)

PRODUCT SPECIFICATION

Product Dimension	390x570x365 mm
Bowl Opening (Inner Dimension)	285X355 mm
Product Net Weight	29.5 kg.
Product Gross Weight	35 kg
Packaging Dimension	590x480x440 mm
Outlet	Horizontal
Inlet Hole And Outlet Hole Dimension	Internal diameter of inlet hole $\varnothing 58 +3/-1$ mm
	External diameter of outlet hole dia. $\varnothing 100 \pm 5$ mm
	Vertical distance between the Floor and the centre line of the waste outlet hole ≤ 225 mm

PRODUCT FEATURES

Product Features	<ol style="list-style-type: none"> 1.Manual Bidet Seat Cover- no batteries or electrical power required 2.Dual function spray - Rear and front wash nozzle 3.Adjustable water pressure for personalized use 4.Anti bacterial seat, 5.Ergonomically designed seat for maximum comfort 6.Sleek design - perfect matching with ceramic bowl, 7. Dual Flush - 6/3 LPF 8.Rimless bowl design with soft close seat cover for smooth operations 9.Detachable seat cover, 10. Anti germ and trap glaze.
------------------	--

ACCESSORIES INCLUDED

PP Seat cover	SPS-WHT-307103PP
Inlet & Outlet gasket	ZPS-WHT-GK01
Side cap	ZPS-WHT-SC01

ACCESSORIES RECOMMENDATION

Rack bolt	ZPS-SNS-RB07N
Concealed cistern	JCS-WHT-2400S, 2400P, 2400, 2400WS, 2400WP, 2400FS, 2400FP, 2431P, 2431FP, 2431, 2431S, 2431FS

CARE AND CLEANING GUIDELINES

- Vitreous china sanitary ware products are fragile in nature and need to be handled with care (to avoid personal injury) at all times during its storage, handling, installation and use thereafter.
- The product is heavy and it is recommended that two persons hold it while it is being fixed.
- Carefully inspect the new product for damage before installation. Recommended to inspect the sanitaryware with wooden Hammer.
- Risk of product damage. Over tightening may cause breakage or chipping of vitreous china. Recommended to use hard rubber & nylon spacer in between ceramic & metal fixtures.
- Risk of external leakage. Do not lift or rock the bowl after placement.
- Always test your cleaning solution on an inconspicuous area on the product before applying it to the entire surface.
- Do not allow cleaners to sit or soak on the product.
- Use a soft, dampened sponge or cloth to clean. Never use abrasive material like a bristle brush or scouring pad.
- Wipe surfaces clean and rinse completely with water immediately after applying cleaners.
- Clean Chrome, stainless steel surfaces once a week. Do not use cleaners containing chloride on chrome, stainless steel. If used, rinse the surface immediately to prevent corrosion.
- Wherever chrome plating is used on the products, use only warm water to clean and then dry with a soft cloth.
- Recommended to use Genuine Accessories.

QUALITY MANAGEMENT SYSTEM - ISO 9001



"DISCLAIMER: Our every effort has been made to ensure factual accuracy, the information presented subject to changes due to requirements in different sites, markets and/ or countries. All dimensions are in mm (Tolerance ± 5 MM). Jaquar reserves the right to make the necessary amendments at any time without prior notice.
For Installation Refer Actual Product.Last modified on January 2026.