

TOP VIEW

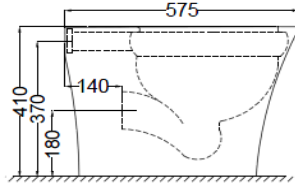

SIDE VIEW

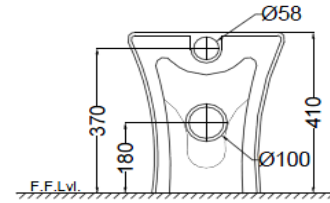

BACK VIEW

General Information

Product Code	ONS-WHT-10955P180UFSM
Brand	Jaquar
Colour	White
Type	Back To Wall WC
Material	Ceramic - Vitreous China

Product Specification

Product Dimension	360x575x410 mm
Inner Dimension	275X340 mm
Product Net Weight	25.5 Kg
Product Gross Weight	27.5 kg
Packaging Dimension	550x370x420mm
Outlet	Horizontal
Inlet And Outlet Hole Dimension	Internal diameter of inlet hole dia. $\varnothing 58 \pm 3$ mm
	External diameter of outlet hole dia. $\varnothing 100 \pm 5$ mm
Waste Hole Horizontal distance	Vertical distance between the Floor and the centre line of the waste outlet hole ≤ 180 mm

Product Features Rimless design with slim seat cover, Dual Flush-3/6 LPF, Anti germ glaze.

ACCESSORIES INCLUDED

UF Soft Close Slim Seat Cover	ONS-WHT-10105
L Type Floor Fixing Kit	ZPS-SNS-FB02
Inlet & Outlet gasket	ZPS-WHT-GK01

ACCESSORIES RECOMMENDATION

Concealed cistern	JCS-WHT-2400, JCS-WHT-2400P, JCS-WHT-2400S, JCS-WHT-2431, JCS-WHT-2431P, JCS-WHT-2431S
-------------------	----------------------------------------------------------------------------------------

CARE AND CLEANING GUIDELINES

→ Vitreous china sanitary ware products are fragile in nature and need to be handled with care (to avoid personal injury) at all times during its storage, handling, installation and use thereafter.

→ The product is heavy and it is recommended that two persons hold it while it is being fixed.

→ Carefully inspect the new product for damage before installation.

→ Risk of product damage. Over tightening may cause breakage or chipping of vitreous china.

→ Risk of external leakage. Do not lift or rock the bowl after placement.

→ Always test your cleaning solution on an inconspicuous area on the product before applying it to the entire surface.

→ Do not allow cleaners to sit or soak on the product.

→ Use a soft, dampened sponge or cloth to clean. Never use abrasive material like a bristle brush or scouring pad.

→ Wipe surfaces clean and rinse completely with water immediately after applying cleaners.

→ Clean Chrome, stainless steel surfaces once a week. Do not use cleaners containing chloride on chrome, stainless steel. If used, rinse the surface immediately to prevent corrosion.

→ Wherever chrome plating is used on the products, use only warm water to clean and then dry with a soft cloth.

QUALITY MANAGEMENT SYSTEM - ISO 9001

DISCLAIMER: Our every effort has been made to ensure factual accuracy, the information presented subject to changes due to requirements in different sites, markets and/ or countries. All dimensions are in mm (Tolerance ± 5 MM). Jaquar reserves the right to make the necessary amendments at any time without prior notice.

For Installation Refer Actual Product